

The Johansson - Plan 8104

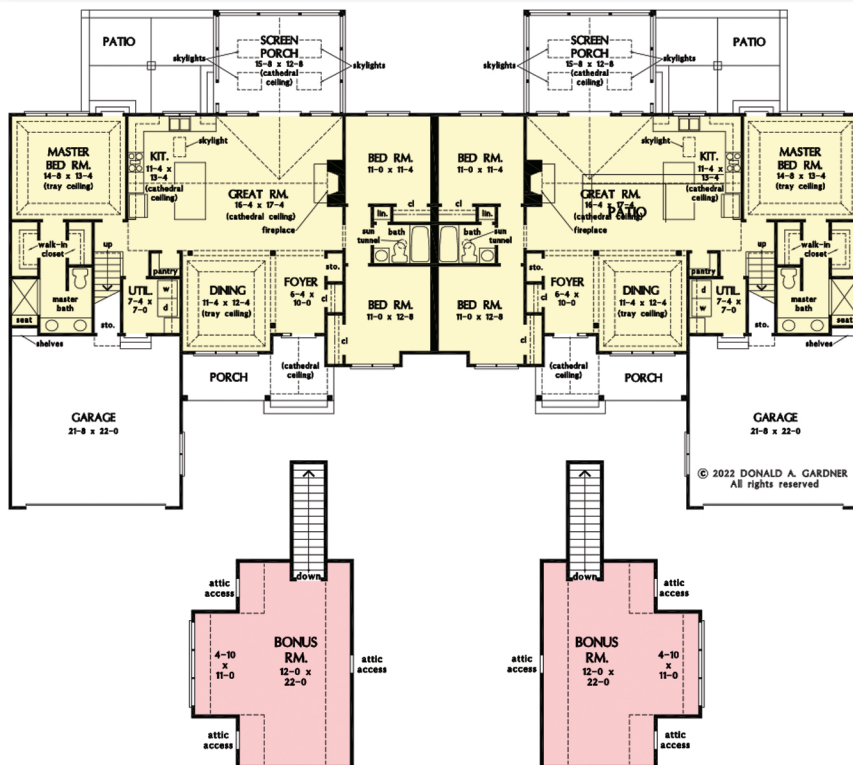

This rustic duplex design features a cedar shake and board-and-batten façade complemented by stone and decorative gable trusses. Each unit enjoys a two-car garage and a spacious rear porch with skylights. The mirrored floor plans consist of an elegant master suite separated from two additional bedrooms. A cathedral ceiling spans the island kitchen and great room, and a large dining room and pantry are nearby. Upstairs, an optional bonus room welcomes expansion.



EACH UNIT

Bedrooms: 3
Baths: 2

1st Floor: 1654
Living Area: 1654
Bonus Room: 334
Foundation: Crawl Space
Width: 54'-10"
Depth: 64'-4"

DUPLEX AS A WHOLE

Width: 109'8" X 64'4"

PRICING

PDF: \$1905
Reproducible PDF

PDF + 5 SETS: \$2205
5 Printed Sets and electronic PDF

CAD: \$3810
AutoCAD file with Unlimited Build